



Euromecc S.r.l.

SS 192 Km 79 - Casella Postale 163
95045 Misterbianco (CT) - Italia
C. Fiscale e P. IVA 02671040877

Tel. +39 095 713 00 11
Mob. +39 331 183 47 41 +39 331 183 47 43
Fax +39 095 713 01 15
<http://www.euromecc.com>
e-mail: repcom@euromecc.com



■ **SERIE 4-5-6 V/E WET**

*Centrali di betonaggio wet idonee al trasporto
in container*

Wet batching plants suitable for transport in container



EURO 4 V/E

Con telo liscio - With flat belt

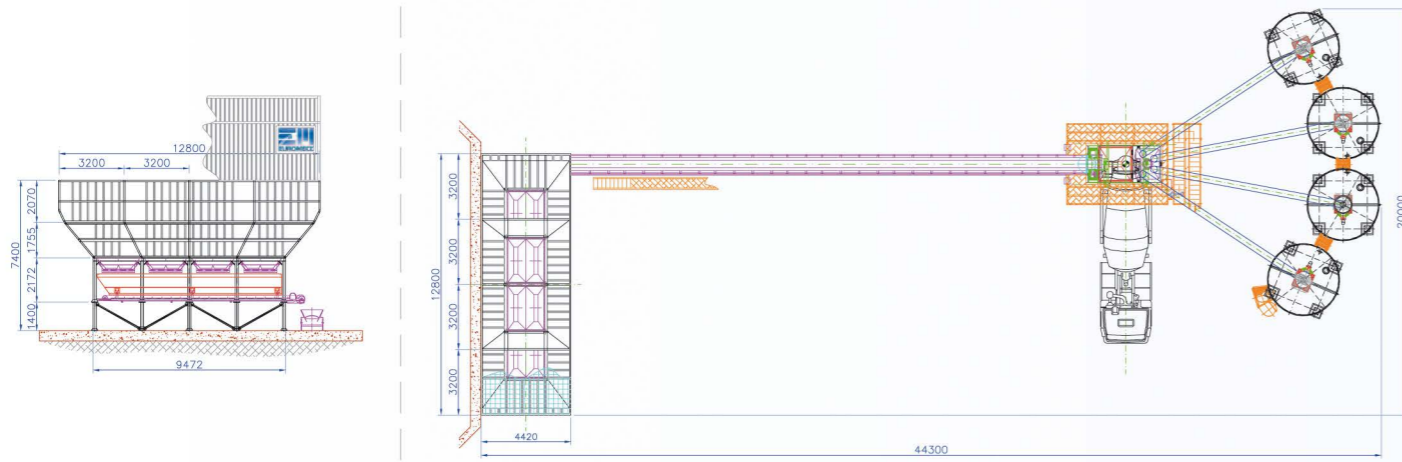

Vista laterale - con skip
Lateral view - with skip

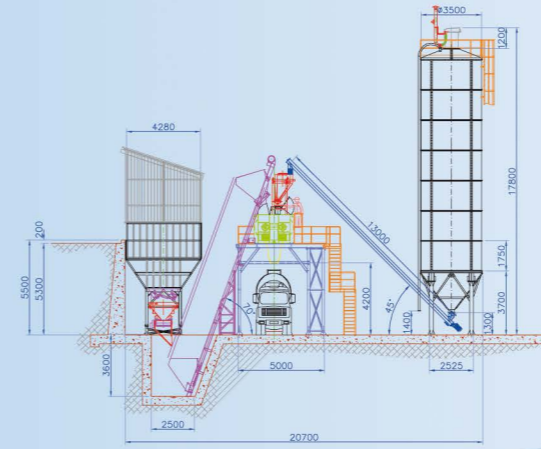

Vista laterale - con nastro caricatore
Lateral view - with loading belt

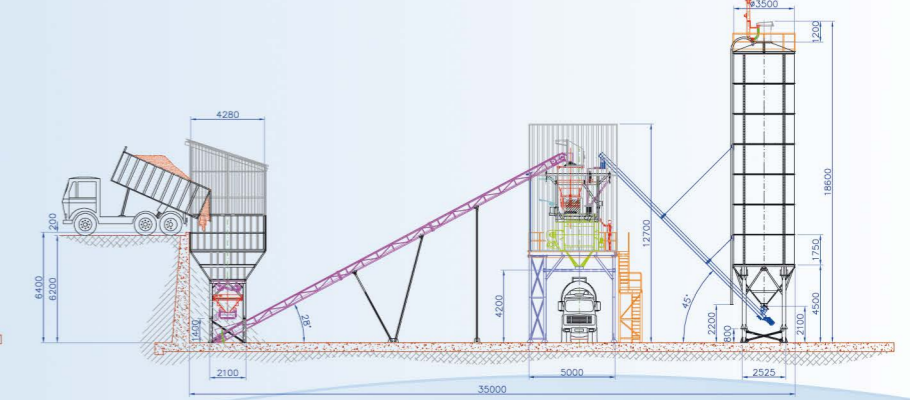

EURO 5 V/E

Con telo listato - With chevron belt

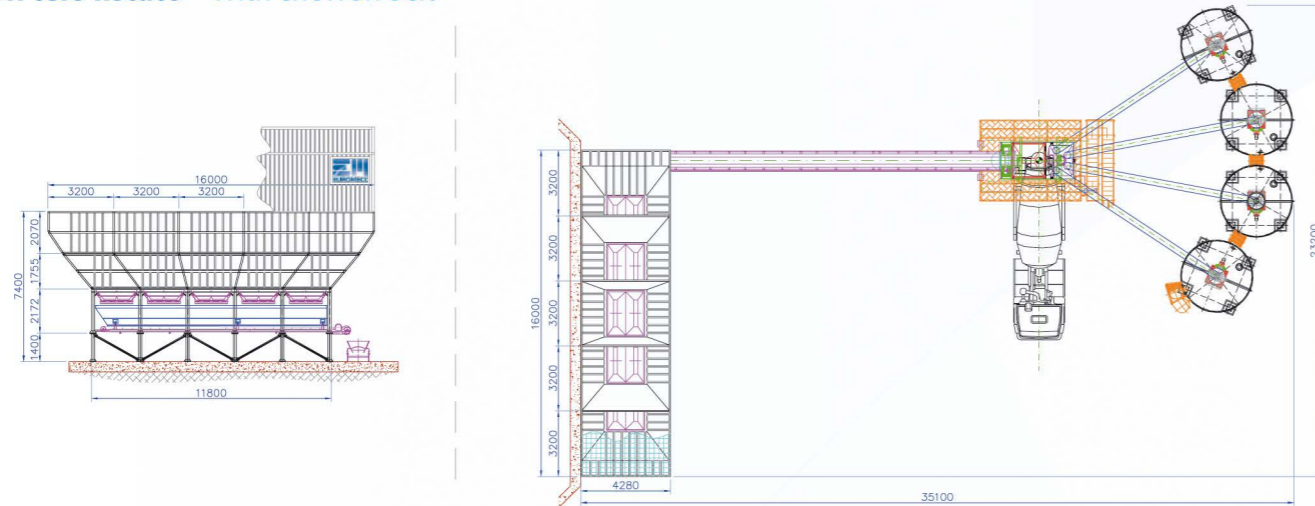

CARATTERISTICHE TECNICHE / TECHNICAL FEATURES

	um	euro 4 V/E	euro 5 V/E	euro 6 V/E
• produzione oraria max - max. hourly output **	m ³ /h	40÷200	40÷200	40÷200
• stoccaggio inerti geometrico (1° - 2° livello di sponde) - aggregate storage real geometric volume (1st - 2nd side panels level)	m ³	65/125	115/150	220***
• stoccaggio inerti a colmo (1° - 2° livello di sponde) - aggregate storage at full capacity (1st - 2nd side panels level)	m ³	95/180	150/220	260***
• vasche inerti - aggregate storage bins	n°	4	5	6
• bocchette/cilindri pneumatici - discharge gates/pneumatic cylinders	n°	8/8	10/10	12/12
• tramoggia pesa inerti - aggregate weighing hopper	m ³	5,5	7	7
• sistema di pesatura inerti - aggregate weighing system	kg	5000	5000	5000
• tramoggia pesa cemento - cement weighing hopper	m ³	1,5	1,5	1,5
• sistema di pesatura cemento - cement weighing system	kg	1500	1500	1500
• tramoggia pesa acqua - water weighing hopper	l	600	600	600
• sistema di pesatura acqua - water weighing system	kg	1000	1000	1000
• nastro estrattore telo 800 mm - extractor belt with sheet 800 mm	m ³ /h	260	260	260
• nastro caricatore telo 800 mm - conveyor belt with sheet 800 mm****	m ³ /h	260	260	260
• Mescolatore a doppio asse orizzontale - resa per ciclo cls vibrato - Twins Shaft Mixer - compacted concrete output per cycle	l	2000	2000	2000
• compressore - air compressor	l	500	500	500
• tensione d'esercizio - operating voltage	V	400	400	400
• frequenza d'esercizio - operating frequency	Hz	50	50	50
• potenza elettrica installata - installed electrical power	HP/kW	180/135	180/135	180/135

*Con mescolatore da 2 m³ di calcestruzzo reso - With mixer max 2 m³ concrete output production / ** In relazione al modello del mescolatore - Depending on the /mixer model
***Versione unica - Only version

ACCESSORI OPZIONALI - OPTIONAL ACCESSORIES

- Struttura portante in acciaio - Steel structure to avoid concrete structure
- Secondo livello di sponde - Second side panels level
- Copertura gruppo vasche e/o mixer - Covering of aggregate bins and/or mixer
- Mescolatore da 1 a 6 m³ reso - Mixer from 1 to 6 m³ concrete output
- Impianto di lavaggio per mescolatore - Water washing system for mixer
- Rivestimenti anti-usura per bocchette e dosatori inerti - Anti-wear lining for aggregate batching gates and aggregate hoppers
- Coclee trasporto cemento - Cement screw conveyors
- Dosatori additivi - Concrete additive batchers
- Misuratori di umidità inerti - Aggregate moisture meters
- Predisposizione per impianto di riscaldamento inerti - Prearrangement for heating equipment
- Dispositivi per aggiunta di ghiaccio all'impasto - Devices for the addition of ice into the mixture
- ****Skip di carico in sostituzione del nastro caricatore e della precarica, se utilizzato mescolatore con resa per ciclo calcestruzzo vibrato < 3,35 m³ - Loading skip in place of loading belt and preload, only if mixer's compacted concrete output per cycle < 3,35 m³



Mescolatore a doppio asse orizzontale da 1 a 6 m³ di resa vibrata
Twin Shaft Mixer from 1 to 6 m³ concrete output production

EURO 6 V/E

Con skip - With skip

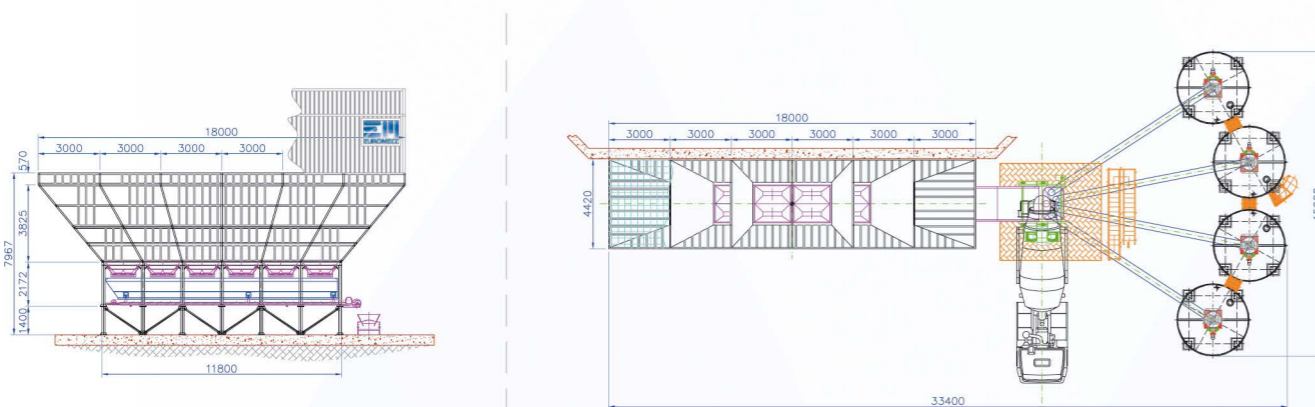

Le informazioni e i dati sono da ritenersi puramente indicativi
All information and data indicated shall be deemed purely indicative



Euromecc S.r.l.

SS 192 Km 79 - Casella Postale 163
95045 Misterbianco (CT) - Italia
C. Fiscale e P. IVA 02671040877

Tel. +39 095 713 00 11
Mob. +39 331 183 47 41 +39 331 183 47 43
Fax +39 095 713 01 15
<http://www.euromecc.com>
e-mail: sales@euromecc.com

Direct contacts:

-  +39 335 715 67 77
-  +39 335 732 09 49
-  +39 335 715 19 19
-  +39 335 679 27 71
-  +39 342 543 93 31
-  +49 172 463 27 00

sales@euromecc.com



■ **SERIE 4-5-6 V/E DRY**

Centrali di betonaggio Dry idonee al trasporto in container
Dry batching plants suitable for transport in container



EURO 4 V/E DRY

UNITS	A	B	C	D	E	F	G
METRIC (mm)	21300	9100	4420	12800	3200	4200	6500
UNITED STATES (ft. - in.)	69' 11"	29' 10"	14' 6"	42'	10' 6"	13' 9"	21' 4"

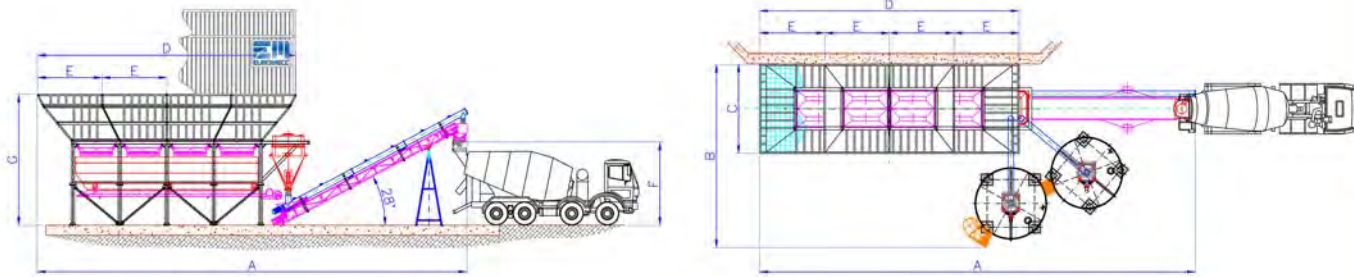

EURO 5 V/E DRY

UNITS	A	B	C	D	E	F	G
METRIC (mm)	16100	17750	4420	16000	3200	11800	7800
UNITED STATES (ft. - in.)	52' 10"	58' 3"	14' 6"	52' 6"	10' 6"	38' 9"	25' 7"

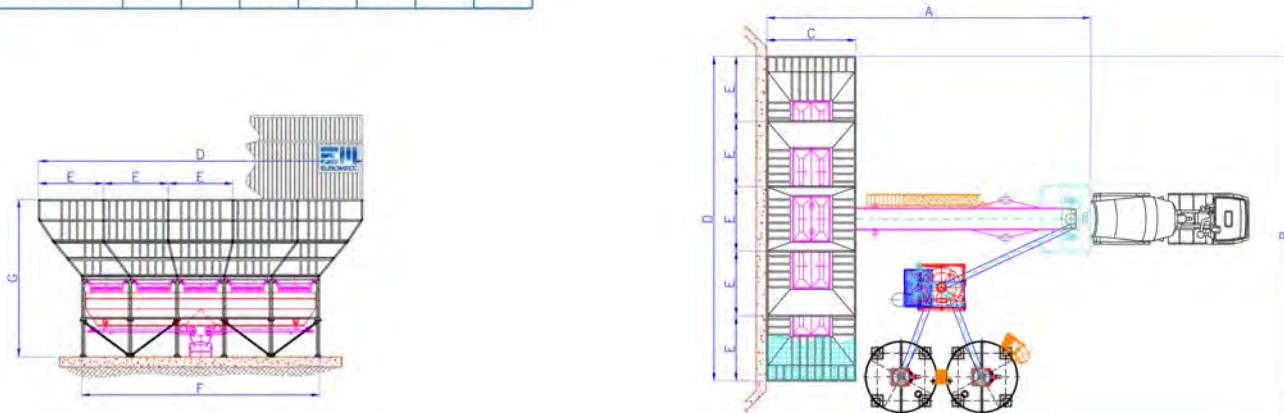

EURO 6 V/E DRY

UNITS	A	B	C	D	E	F	G
METRIC (mm)	16100	18700	4420	18000	3000	11800	8400
UNITED STATES (ft. - in.)	52' 10"	61' 4"	14' 6"	59' 1"	9' 10"	38' 9"	27' 7"

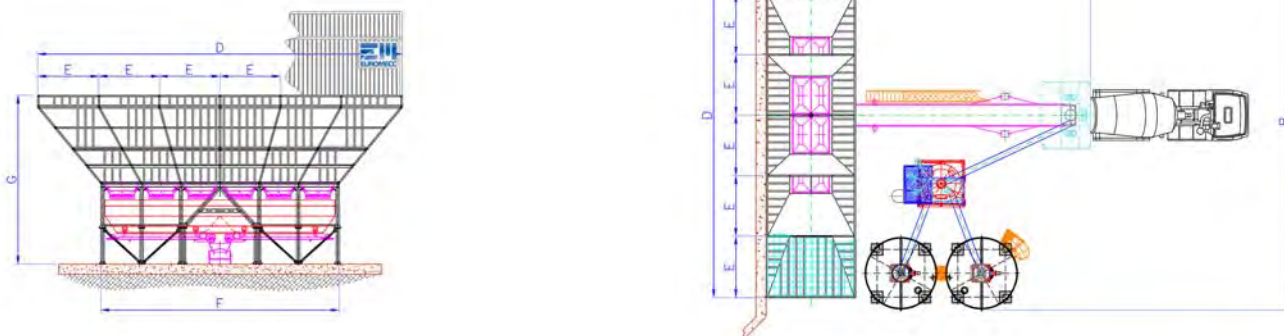

Vista laterale

Lateral view

UNITS	A	B	C	D
METRIC (mm)	16100	4420	3500	4200
UNITED STATES (ft. - in.)	52' 10"	14' 6"	11' 6"	13' 9"

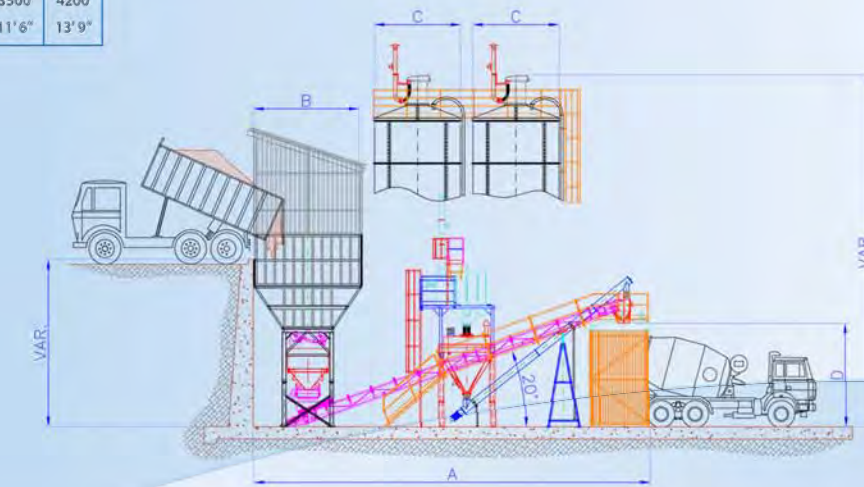

CARATTERISTICHE TECNICHE / TECHNICAL FEATURES*	METRIC UNITS				UNITED STATES UNITS			
	um	euro 4 V/E	euro 5 V/E	euro 6 V/E	um	euro 4 V/E	euro 5 V/E	euro 6 V/E
• produzione oraria max - max. hourly output	m³/h	80	80	80	yd³/h	105	105	105
• stoccaggio inerti geometrico - aggregate storage real geometric volume	m³	65/125	115/150	220*	yd³	85/163	150/196	288*
• stoccaggio inerti a colmo - aggregate storage at full capacity	m³	95/180	150/220	260*	yd³	124/235	196/288	340*
• vasche inerti - aggregate storage bins	n°	4	5	6	n°	4	5	6
• bocchette/cilindri pneumatici - discharge gates/pneumatic cylinders	n°	8/4	10/5	12/6	n°	8/4	10/5	12/6
• tramoggia pesa inerti - aggregate weighing hopper	m³	18**	18	18	yd³	24**	24	24
• sistema di pesatura inerti - aggregate weighing system	kg	20000	20000	20000	lb	44,092	44,092	44,092
• tramoggia pesa cemento - cement weighing hopper	m³	5	5	5	yd³	6.5	6.5	6.5
• sistema di pesatura cemento - cement weighing system	kg	5000	5000	5000	lb	11,023	11,023	11,023
• dosaggio acqua con lancia impulsi elettromeccanico - water batching with electromechanical pulse emitter	∅	2"	2"	2"	∅	2"	2"	2"
• nastro estrattore telo 800 mm - extractor belt with sheet 800 mm	m³/h	90÷180	90÷180	90÷180	yd³/h	118÷235	118÷235	118÷235
• nastro caricatore telo 800 mm - conveyor belt with sheet 800 mm	m³/h	180	180	180	yd³/h	235	235	235
• coclea di carico ø273 mm - loading screw diameter Ø 273 mm	t/h	60	60	60	lb/s	33	33	33
• compressore - air compressor	L	270/500***	270/500***	270/500***	gal	71/132***	71/132***	71/132***
• tensione d'esercizio - operating voltage	V	400	400	400	V	460	460	460
• frequenza d'esercizio - operating frequency	Hz	50	50	50	Hz	60	60	60
• potenza elettrica installata - installed electrical power	hp/kW	68/50	68/50	68/50	hp/kW	68/50	68/50	68/50

* versione unica - only version / ** con spondine - with small side panels / *** in presenza di cappa d'aspirazione - with suction hood

ACCESSORI OPZIONALI - OPTIONAL ACCESSORIES

- Struttura portante in acciaio - Steel structure to avoid concrete structure
- Secondo livello di sponde - Second side panels level
- Copertura gruppo vasche - Covering of aggregate bins
- Sistemi di pesatura inerti da kg 25000 per dosaggio da 12 m³ - 55000 lb aggregate weighing system for batching 15.7 yd³
- Rivestimenti anti-usura per bocchette e dosatori inerti - Anti-wear lining for aggregate batching gates and aggregate hopper
- Coclee trasporto cemento - Cement screw conveyor
- Dosatori additivi - Concrete additive batchers
- Misuratori di umidità inerti - Aggregate dampness counters
- Predisposizione per impianto di riscaldamento inerti - Prearrangement for heating equipment
- Dispositivi per aggiunta ghiaccio all'impasto - Devices for the addition of ice into the mixture



Le informazioni e i dati sono da ritenersi puramente indicativi
All information and data indicated shall be deemed purely indicative



Euromecc S.r.l.

SS 192 Km 79 - Casella Postale 163
95045 Misterbianco (CT) - Italia
C. Fiscale e P. IVA 02671040877

Tel. +39 095 713 00 11
Mob. +39 331 183 47 41 +39 331 183 47 43
Fax +39 095 713 01 15
<http://www.euromecc.com>
e-mail: repcom@euromecc.com



■ **SERIE MAX**

*Impianti di betonaggio dall'elevata capacità produttiva
e di stoccaggio idonei sia per produzioni Dry che Wet*

*Concrete Batching Plants with high production and
storage capacity suitable both for Dry and Wet production*

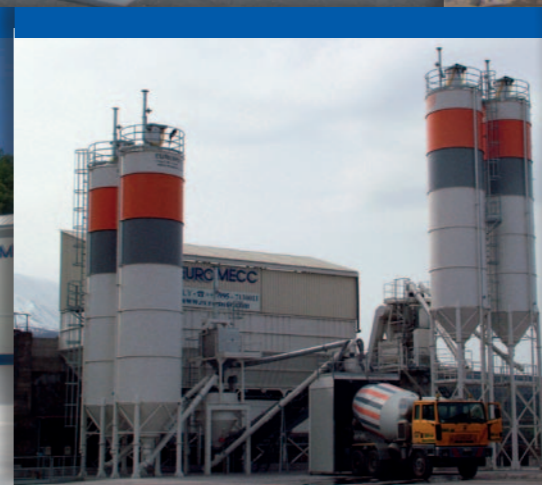
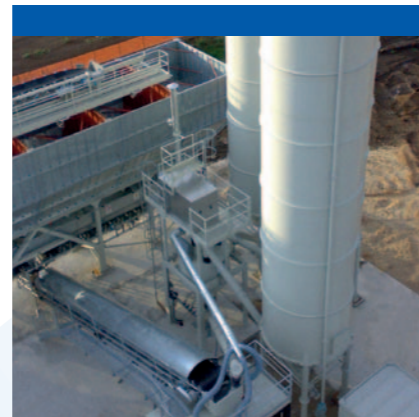

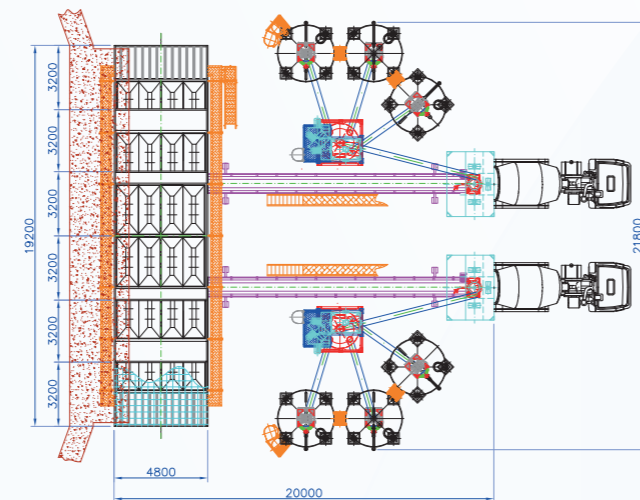
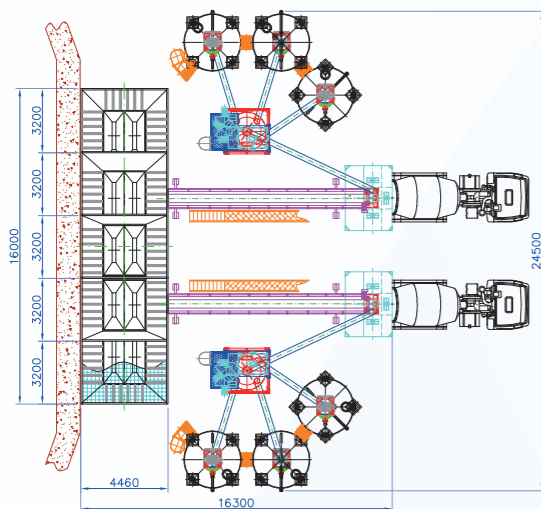
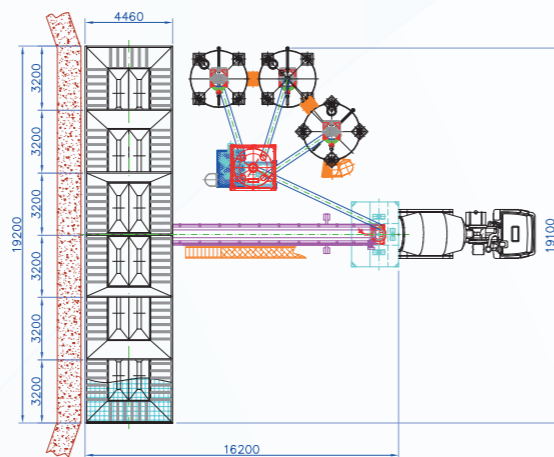
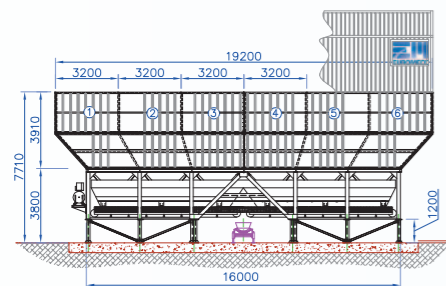
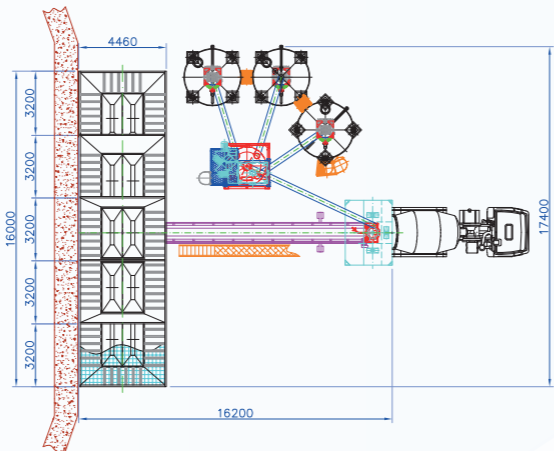
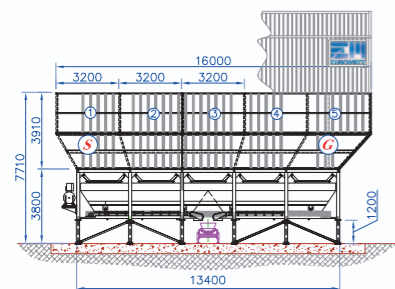
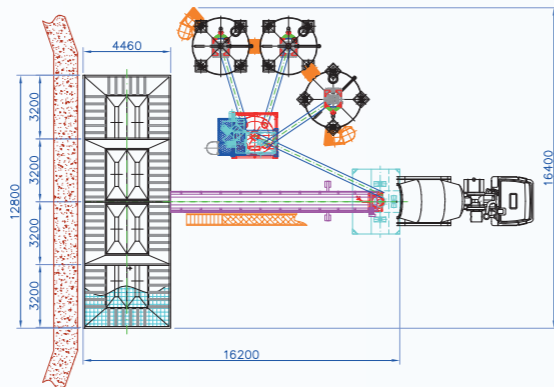
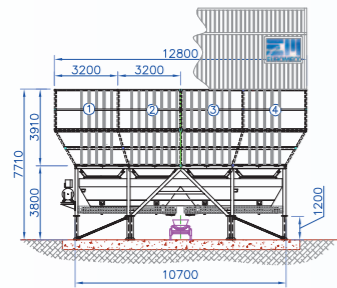

Vista laterale - Lateral view

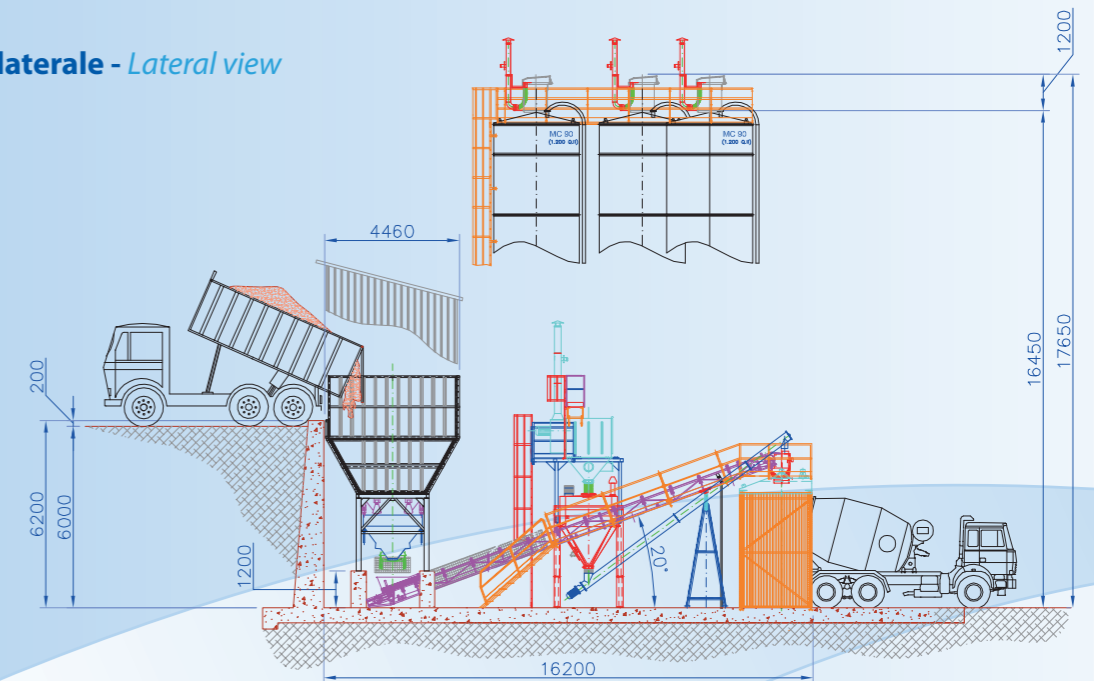

CARATTERISTICHE TECNICHE / TECHNICAL FEATURES

	um	4max	5max	6max	5dpmax	6dpmax	5dpmax2t	6dpmax2t
• stoccaggio inerti geometrico - aggregate storage - real geometric volume	m ³	175	220	260	220	260	300	360
• stoccaggio inerti a colmo - aggregate storage - at full capacity	m ³	215	255	315	255	315	350	425
• produzione oraria - hourly output	m ³ /h	90	90	90	2 x 90	2 x 90	2 x 90	2 x 90
• vasche inerti - aggregate storage bins	n°	4	5	6	5	6	6	6
• bocchette/cilindri pneumatici - discharge gates/pneumatic cylinders	n°	8/8	10/10	12/12	10/10	12/12	20/20	24/24
• tramoggia pesa inerti aggregate weighing hopper	m ³	12	27	32	2 x 25	2 x 25	2 x 27	2 x 32
• sistema di pesatura inerti - aggregate weighing system	kg	25000	25000	25000	2 x 25000	2 x 25000	2 x 25000	2 x 25000
• tramoggia pesa cemento - cement weighing hopper	m ³	5,2	5,2	5,2	2 x 5,2	2 x 5,2	2 x 5,2	2 x 5,2
• sistema di pesatura cemento - cement weighing system	kg	6000	6000	6000	2 x 6000	2 x 6000	2 x 6000	2 x 6000
• dosaggio acqua con lancia impulsi elettromeccanico - water batching with electromechanical pulse emitter	ø	3"	3"	3"	2 x 3"	2 x 3"	2 x 3"	2 x 3"
• nastro estrattore telo 800 mm - extractor belt with sheet 800 mm	m ³ /h	90	90	90	60 ÷ 180	60 ÷ 180	60 ÷ 180	60 ÷ 180
• nastro caricatore telo 800 mm - conveyor belt with sheet 800 mm	m ³ /h	180	180	180	2 x 180	2 x 180	2 x 180	2 x 180
• codlea di carico ø273 sotto dosatore - conveyor screw ø273 - under scale	t/h	60	60	60	2 x 60	2 x 60	2 x 60	2 x 60
• compressore - air compressor	l	500	500	500	2 x 500	2 x 500	2 x 500	2 x 500
• tensione d'esercizio - operating voltage	V	400	400	400	400	400	400	400
• frequenza d'esercizio - operating frequency	Hz	50	50	50	50	50	50	50
• potenza elettrica installata - installed electrical power	HP/kW	68/50	68/50	68/50	2 x 68/50	2 x 68/50	2 x 68/50	2 x 68/50

ACCESSORI OPZIONALI - OPTIONAL ACCESSORIES

- Struttura portante in acciaio - Steel structure to avoid concrete structure
- Tamponatura - Covering of aggregate bins
- Sistemi di caricamento inerti con nastro o elevatore a tazze - Aggregate loading from ground with conveyor belt or bucket elevator
- Rivestimenti anti-usura per bocchette e dosatori inerti - Anti-wear lining for aggregate batching gates and aggregate hopper
- Codlee trasporto cemento - Cement screw conveyor
- Dosatori additivi - Concrete additive batcher
- Misuratori di umidità inerti - Aggregate dampness counter
- Predisposizione per impianto di riscaldamento inerti - Prearrangement for heating equipment
- Dispositivi per aggiunta ghiaccio all'impasto - Devices for the addition of ice into the mixture
- Pannelli perimetrali di ispezione bocchette - Perimeter Panels for gates inspection

Le informazioni e i dati sono da ritenersi puramente indicativi
All information and data indicated shall be deemed purely indicative

